

PROPORTIONING AND BY-PASS VALVE (P & B VALVE)

ON-VEHICLE INSPECTION

1. INSTALL LSPV GAUGE (SST) AND BLEED AIR

- Turn the ignition switch OFF, depress the brake pedal more than 40 times.
- Install the LSPV gauge (SST) and bleed air.

SST 09709-29018

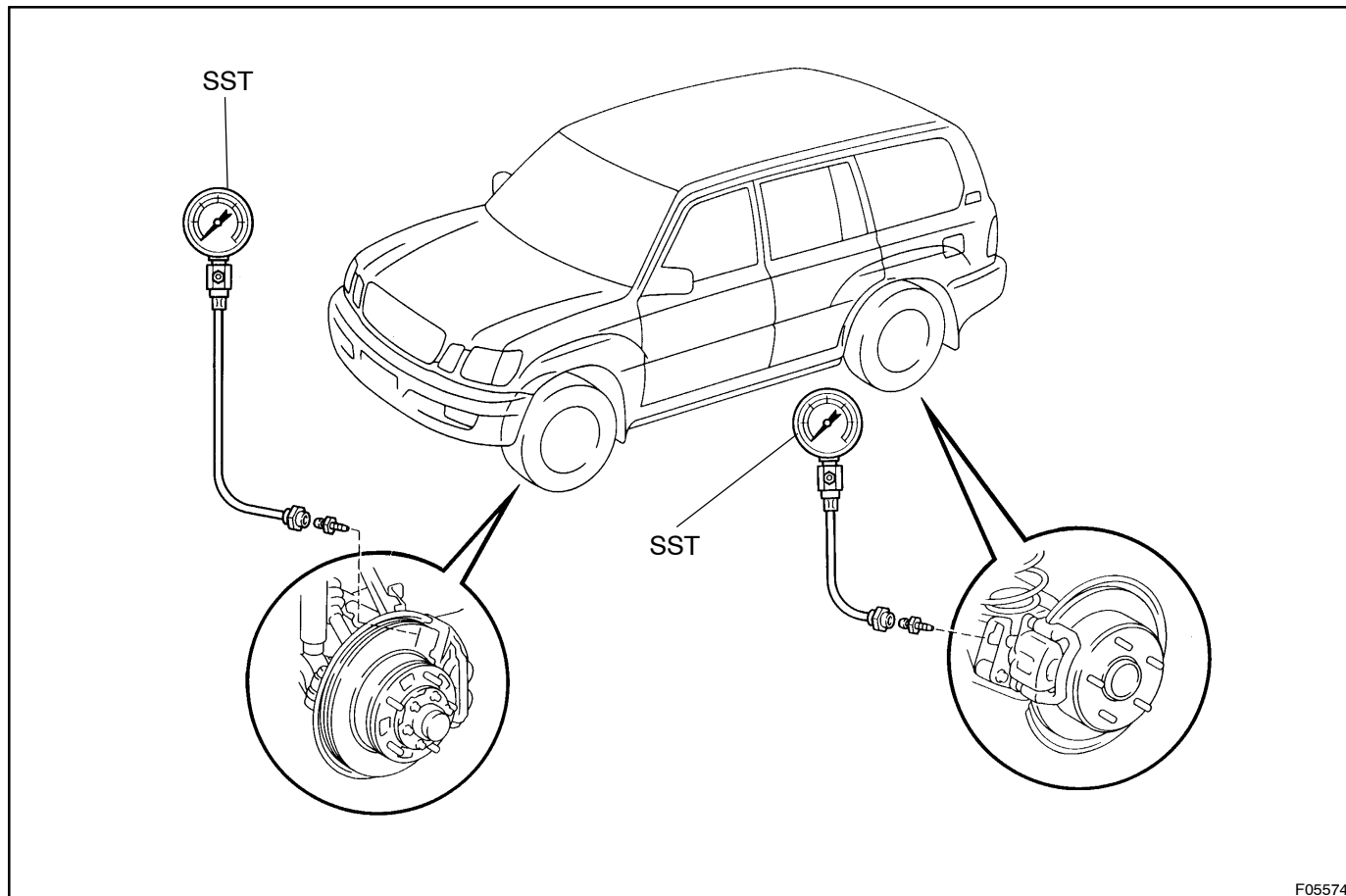

F05574

- Turn the ignition switch ON, and wait until the pump motor has stopped.

2. RAISE FRONT BRAKE CALIPER PRESSURE AND CHECK REAR BRAKE CALIPER PRESSURE

- Depress the brake pedal and check fluid pressure.

Front brake caliper pressure	Rear brake caliper pressure
2,206 kPa (22.5 kgf·cm ² , 320 psi)	2,305 kPa (23.5 kgf·cm ² , 334 psi)
7,845 kPa (45 kgf·cm ² , 1,138 psi)	3,334 – 3,727 kPa (34 – 38 kgf·cm ² , 484 – 540 psi)
7,796 kPa (79.5 kgf·cm ² , 1,131 psi)	5,197 kPa (53 kgf·cm ² , 754 psi)

If the rear brake caliper pressure is incorrect, replace the hydraulic brake booster.

3. BLEED BRAKE SYSTEM (See page BR-4)

4. CHECK FOR FLUID LEAKAGE